

41 Richmond Court,
200 Sloane Street, SW1X 9QU
Approximate Gross Internal Area
64.07 sq m / 690 sq ft

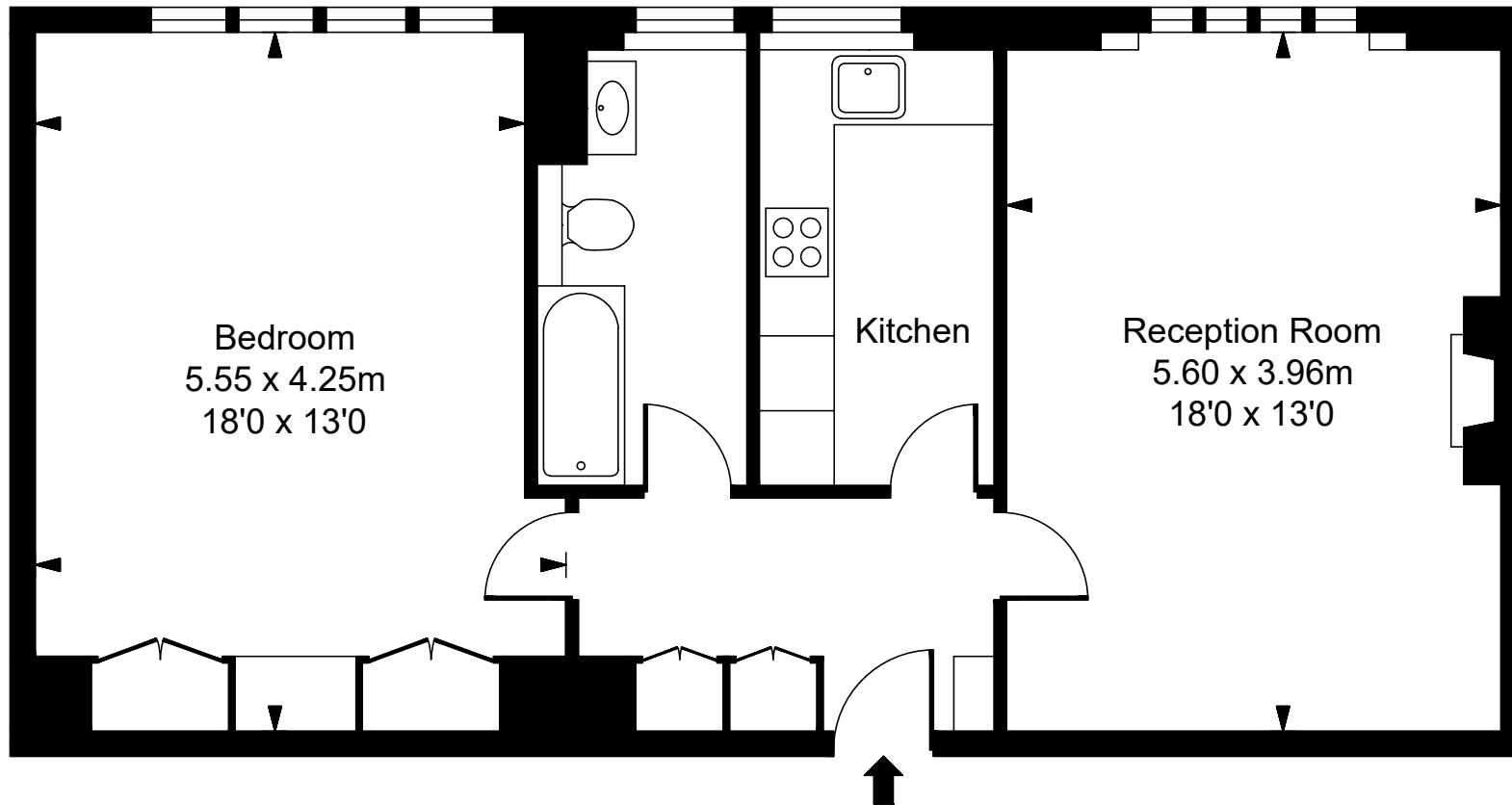

Fifth Floor

ILLUSTRATION FOR IDENTIFICATION PURPOSES ONLY
ALL MEASUREMENTS ARE MAXIMUM, AND INCLUDE WINDOW BAYS AND WARDROBES WHERE APPLICABLE
THIS PLAN MUST NOT BE REPRODUCED BY ANY OTHER PERSON WITHOUT PERMISSION

